



AUGER ASSEMBLY INSTRUCTION



FOR ELECTRIC OR HYDRAULIC AUGERS

AUGER SECTIONS

SECTION A: Outlet one side (hydraulic or electric), 2 punch marks on flange at the other side.

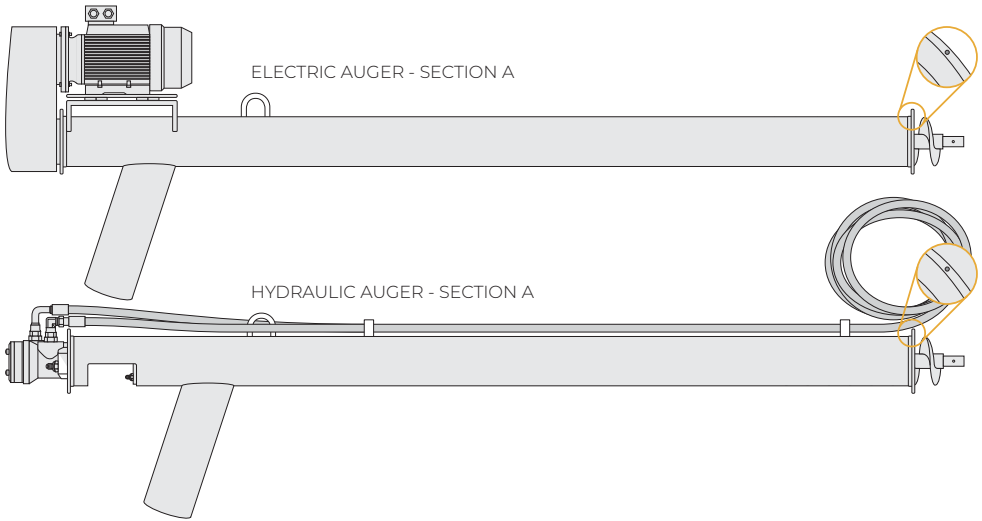

SECTION B: 2 Punch marks on flange one side, 1 punch mark on the flange at the other side.

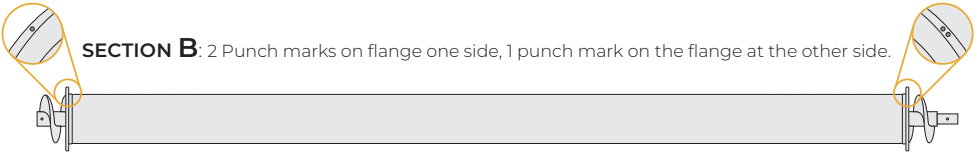

SECTION C: 1 Punch mark on flange one side with the intake on the other side.

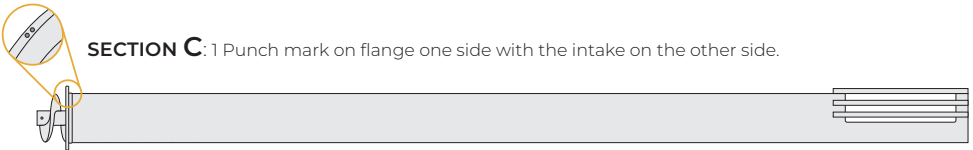

SECTION D:
Main stand

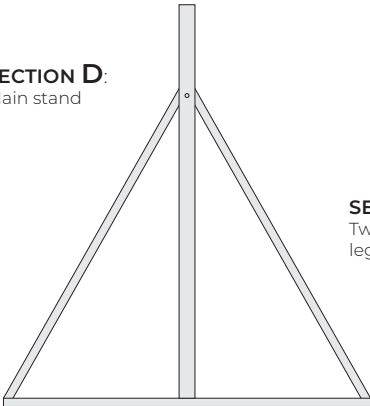

SECTION E:
Two stabilising
legs



SECTION F:
Swivel head clamp



SECTION G:
Grain chute



AUGER ASSEMBLY

STEP 1

Attach the spiral from Section A to the spiral from Section B, making sure the spiral curves overlap.

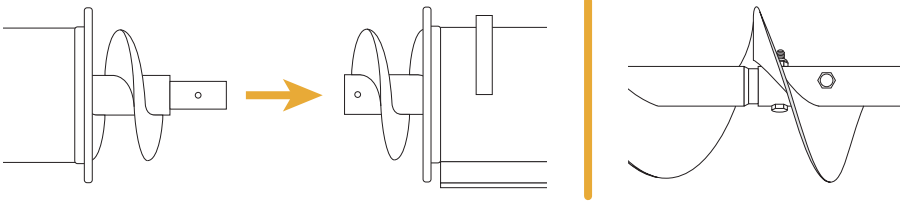

STEP 2

Attach the two flanges from Section A to Section B, making sure that the punch marks line up.

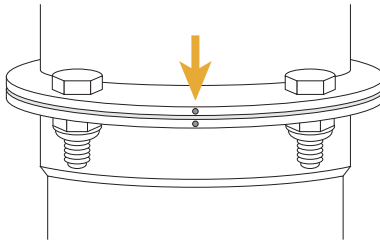

STEP 3

Repeat Step 1 and 2 by attaching Section B to Section C. Make sure that all the punch marks correlate and line up.

Section A to Section C should form one full auger and look as follows:

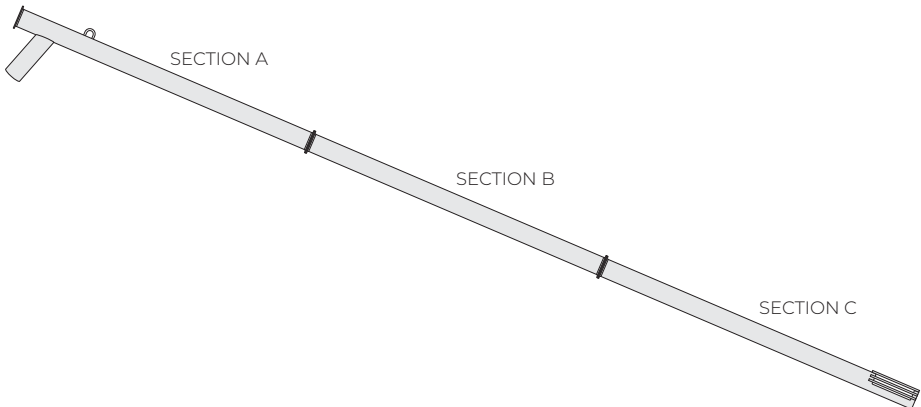

STAND ASSEMBLY TO AUGER

STEP 1

Attach the two legs of Section E on either side of the main stand (Section D), creating the support stand with four legs.

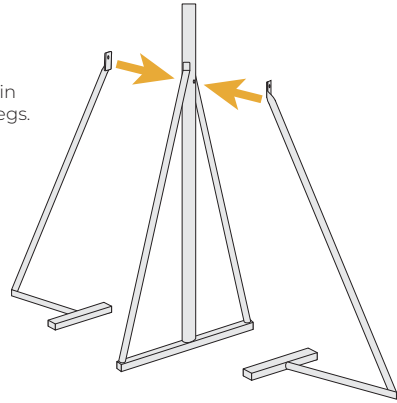

STEP 2

Attach the swivel head clamp (Section F) just behind the top flange of Section B.

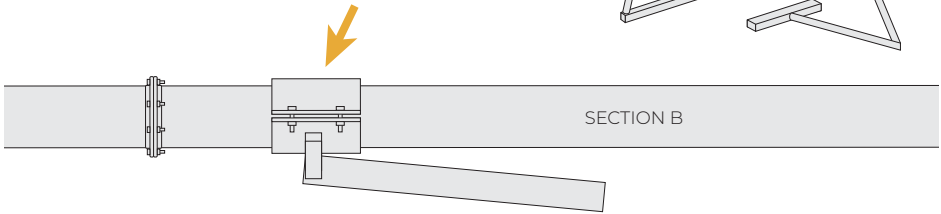

STEP 3

Lift the whole auger and slide the shaft of the swivel head clamp (Section F) into the stand built in Step 1.

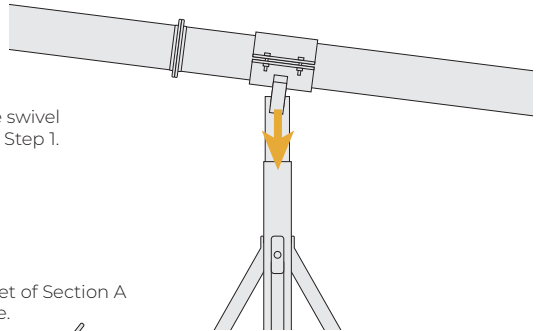

STEP 4

Attach the grain chute (Section G) to the outlet of Section A and adjust the chain length for optimal usage.

